

# MAARMO

SHAPING FUTURE OF ITALIAN DESIGN

## INSTALLATION AND MAINTANCE ELECTRICAL MANUAL



## INDEX

1. GENERAL INFORMATION .....	3
1.1 Product information .....	3
1.2 General Warnings / Safety information .....	4
1.3 Datasheet .....	6
2. EQUIPMENT .....	7
2.1 Accessories provided with the decorative radiator .....	7
2.2 Equipment needed .....	7
2.3 Installation procedure .....	8
2.4 Special notes for bathroom installation .....	9
2.5 Dimensions and footprint .....	10
2.6 Electric connections .....	12
3. INSTALLATION STEPS .....	14
3.1 STEP 1: Preparing the electrical plug .....	14
3.2 STEP 2: Installation .....	14
3.3 STEP 3: Installation on the wall .....	15
4. WARRANTY AND ASSISTANCE .....	17
5.1 Technical assistance .....	17
5. DECLARATION OF CONFORMITY .....	18

## 1. GENERAL INFORMATION

### 1.1 Product information



Dear Customer:

Thank you for your preference.

Before installing your MAARMO decorative radiator, please read this manual carefully. It contains general information about the product, the correct installation method, safety instructions and the warranty.

Maarmo decorative radiators represent a new patented and entirely eco-sustainable technology capable of transmitting heat by radiation to all rooms. The production process respects and pays attention to environmental sustainability by reusing marble processing waste. The waste marble powder is agglomerated with water, special binders and thickeners researched and produced by our craftsmen.

Our mission is to take care of people by spreading warmth and wellbeing in the environments in which they live, with the creativity and commitment that has always distinguished Made in Italy products.

Comfort and quality of life are the goal of our passion and research for continuous innovation, aimed at using recycled materials with new and technological production processes where architectural design and respect for the environment are inseparable values.

We believe that only a sustainable, responsible vision and conduct will allow us to preserve future generations.

This is what we believe in at Maarmo and this is what we work towards every day, creating innovative and sustainable products.





## 1.2 Safety information

- For the installation of the MAARMO heating unit it is recommended to contact a qualified professional.
- Check the condition of the support before installing the decorative radiator.
- Choose suitable screws for the existing support.
- During the installation pay attention to the water pipes and electrical cables.
- During installation, maintenance and cleaning the panel must be switched off and not electrically powered.
- Do not clean with chemicals or alcohol products.
- Cleaning must be carried out by adults who are familiar with the product and its operation.
- The panel is intended to heat rooms, any other use is prohibited.
- To avoid overheating, do not cover the panel.
- The heating appliance should not be placed just below a socket-outlet.
- The panel can reach very hot temperatures, so take special care if children or vulnerable persons are present.
- Do not dismantle or modify the radiator.
- Do not use the appliance if it is visually damaged: switch off the power and contact the service centre.
- If the electric cable is damaged, it must be replaced by the manufacturer, its after-sale service or by people of similar qualification, in order to avoid any danger. Do not attempt to repair the thermostat, but contact the service centre.
- Do not install the heating unit under electrical outlets.
- The decorative radiator must not be installed behind curtains.
- Leave at least 100 mm of space around the device
- Only to be used with the external controller (thermostat) supplied with each radiator
- DO NOT twist or jam the cable in the radiator wings behind it. If the cable is damaged, you risk very serious wounds that could lead to death. After its replacement, if the assembly was not carried out properly, you risk the same wounds.
- In order to avoid any risk of electrocution: Do not take apart the electronic thermostat which has been assembled in the factory. Do not introduce a metallic object into the thermostat. The electrical cable integrated in the factory is not replaceable; delivered in a standard length it should not be extended, nor shortened.

Maarmo reserves the right to modify the manual at any time with the aim of making the information clearer, to add or remove any part without having to inform customers in an obvious manner.

The installation manual can also be consulted at <https://www.maarmo.it/download/>.

## PLEASE TAKE NOTE



### SAFETY PRECAUTIONS

Your radiator is a fragile and heavy item, please handle with care.

Please ensure you thoroughly read the instructions before mounting to ensure safety, protection and maximum strength. Should your radiator be installed on plasterboard walls, heavy duty fixings are those that can take a large amount of weight and must be used to guarantee maximum safety.

It is the responsibility of the purchaser and/or installer to verify that the mounting surface is solid and capable of supporting the weight of the radiator. It is recommended to consult with a professional and determine the appropriate fastener/anchor needed for the mounting surface.

## 1.3 Datasheet

Model	MAE0311	MAE0318	MAE0511	MAE0515	MAE0518	MAE0508
Nominal Power	350 W	500 W	600 W	1000 W	1400 W	500 W
Supply	230Vac +/-10% 50 Hz					
Electric insulation	CLASS II					
Enclosure Degree	IPX4					
Dimensions L*H*P Vertical Installation	300x1100x70	300x1800x70	550x1100x70	550x1500x70	550x1800x70	550x860x70
Weight	19 kg	34 kg	36 kg	48 kg	58 kg	27 kg
MODELS						
PERFETTO	MAE0311PER	MAE0318PER	MAE0511PER	MAE0515PER	MAE0518PER	MAE0508PER
TOSCANA	MAE0311TOS	MAE0318TOS	MAE0511TOS	MAE0515TOS	MAE0518TOS	MAE0508TOS
TESSUTO	MAE0311TEE	MAE0318TEE	MAE0511TEE	MAE0515TEE	MAE0518TEE	MAE0508TEE
GINKO	MAE0311GNK	MAE0318GNK	MAE0511GNK	MAE0515GNK	MAE0518GNK	MAE0508GNK
CURVE	MAE0311CRV	MAE0318CRV	MAE0511CRV	MAE0515CRV	MAE0518CRV	MAE0508CRV
FIXING DIST. VERT. DxH	140x1010	140x1710	380x745	380x990	380x1370	380x1710
FIXING DIST. HORIZ DxH	1010x140	1710x140	340x500	550x500	850x500	1710x380
Supply Cable	Length 1200 mm, without cap, 3*1 with pilot thread at bottom right.					
Using Temp.	0 – 50°C					
Storage Temperature	0 – 85°C					
Humidity	0 - 85% non-condensing					
Temperature Regulation	Digital; programmable (24 h) per day					
Temperature setting Range	7 – 30°C					
Temperature read Resolution	1/10°C					
Certifications	CE					
European Standards	2006/95/CE, 2004/108/CE, 2002/96/CE					
Armonized Standards	EN 60335-1 (2004-04), EN 60335-2-30 (2006-05), EN 60335-2-43					



## 2. EQUIPMENT

### 2.1 Accessories provided with the radiator

The following items are supplied with each MAARMO electric radiator:

- n.2 hangers, metal elements of various shapes that allow them to be hung from hooks embedded in the wall (F1);
- n.2 anti-hooking safety lock (F2)
- n.2 spacer feet (F3)
- n.2 screws and dowels (F4)
- n.2 retaining screws (F5)
- n.2 spacer (F6)
- n.2 thermostat (see separate instruction manual)
- n.2 cover hangers (carter)



*Packed accessories bag*

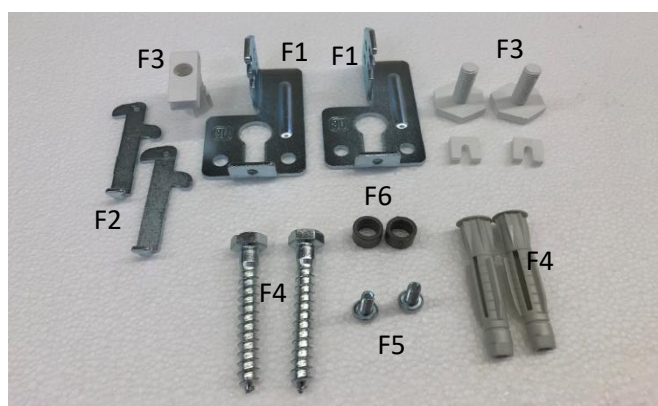

*Accessories bag content*



*Cover hangers*



*Thermostat*



*Electrical control*

## 2.2 Equipment needed

The following equipment is required for the installation of the MAARMO heating unit:

- Gloves, safety shoes and glasses;
- Drill - 10 mm drill bit, tape measure, spirit level, screwdriver, pencil/pen.

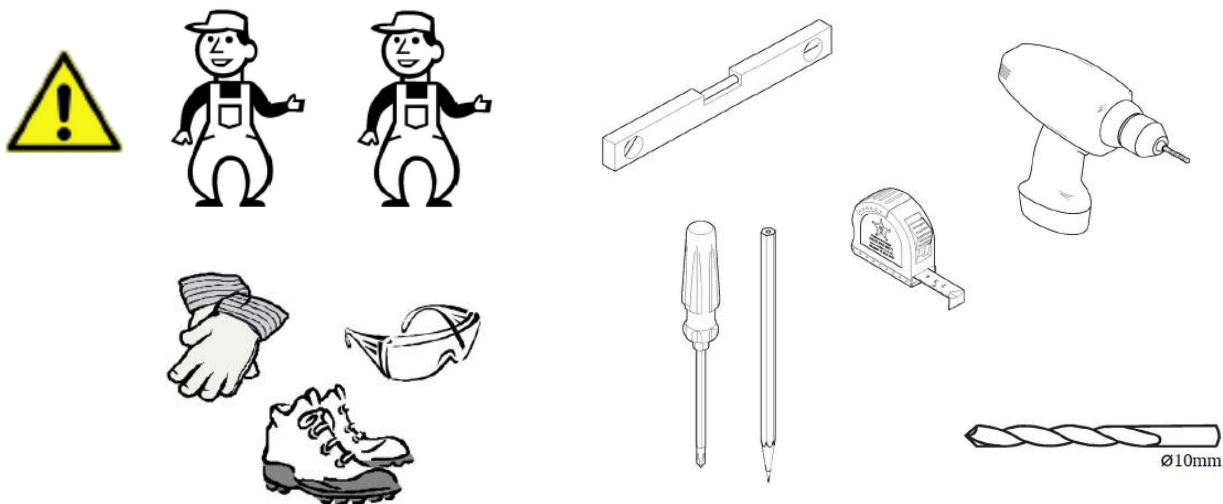

## 2.3 Installation procedure

- Before installation, check the correct position of the radiator in the room in relation to other elements of furniture (e.g., curtains, drawer units) and in relation to the perimeter walls.
- The supplied anchor kit must only be used on concrete, solid brick, perforated brick, compact stone; always check that the support is suitable for the weight, and if necessary, replace the supplied plug with a model suitable for the support used.

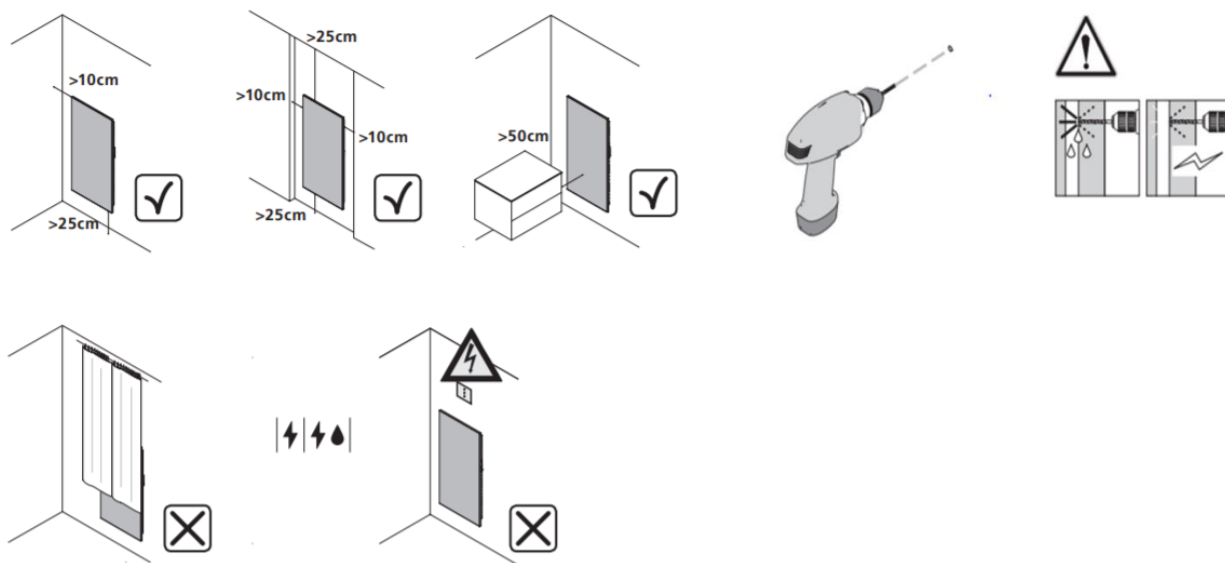



## 2.4 Special notes for bathroom installation

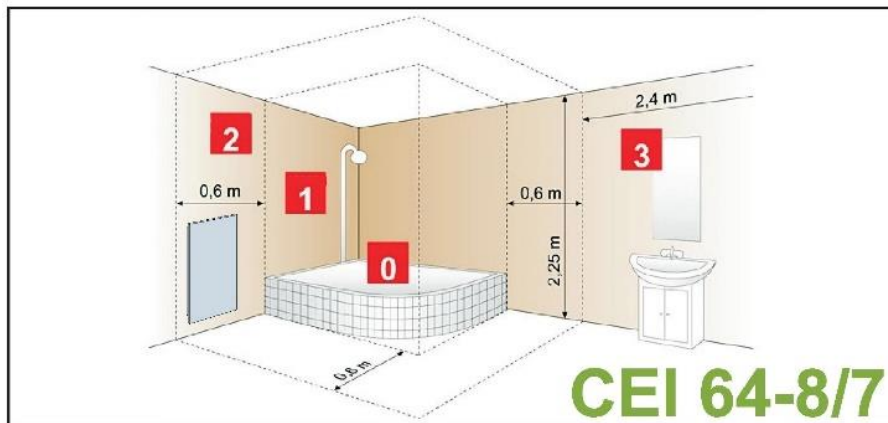

The installation must comply with the laws and regulations of the country in which it is installed. The device can be installed in zone 2 and 3, but CANNOT be installed in zone 0 and 1 in reference to CEI 64-8/7 art. 701.32. so that the device cannot be reached by someone using the shower or bathtub.



## 2.5 Dimensions and footprint

- The junction box must be at least 300 mm from the floor and at least 100 mm from the radiator (as shown in the picture).
- Leave at least 100 mm of space around the unit (250 mm from the floor).

Misura mm	VERTICALE		ORIZZONTALE	
	A	B	A	B
300X1100	380	105	340	45
300X1800	380	105	550	45
550X860	380	105	850	45
550X1100	380	105	1030	45
550X1500	140	85	580	65
550X1800	140	85	1300	65
400X1600	204	105	850	55
600X1100	380	105	550	55

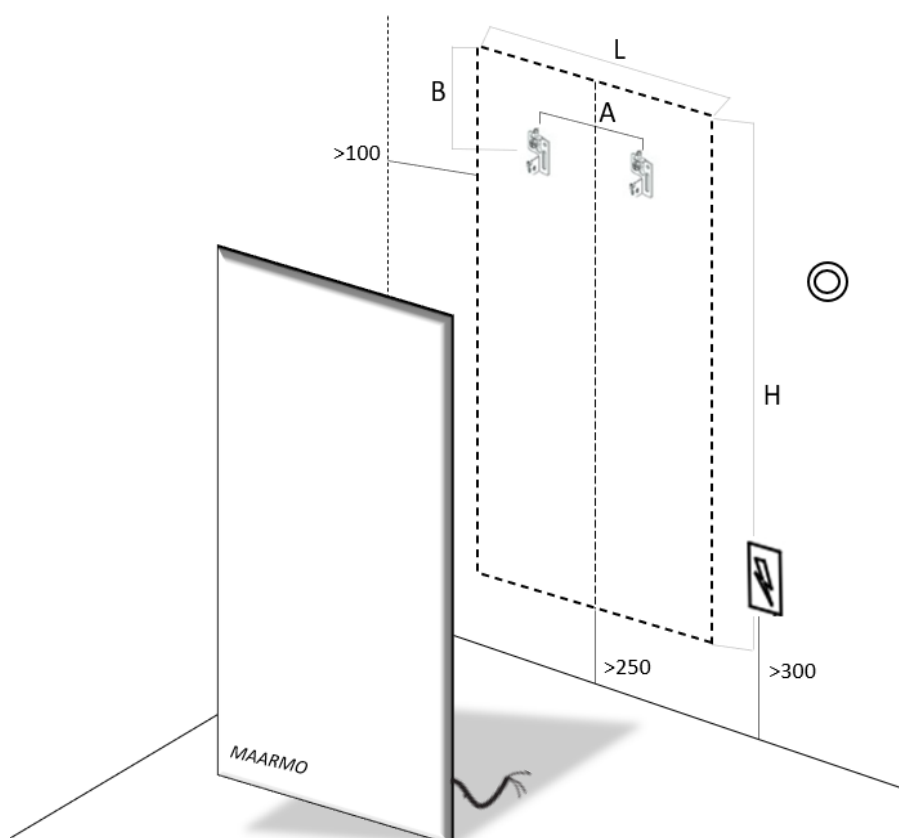

The electric version of the MAARMO heater can be positioned either horizontally or vertically.

For proper installation of the MAARMO heater in the vertical position, make sure that the MAARMO logo is located on the lower left as shown and that the control unit (mounted on the back) is located on the bottom of the heater.

FRONT VIEW IN  
VERTICAL POSITION

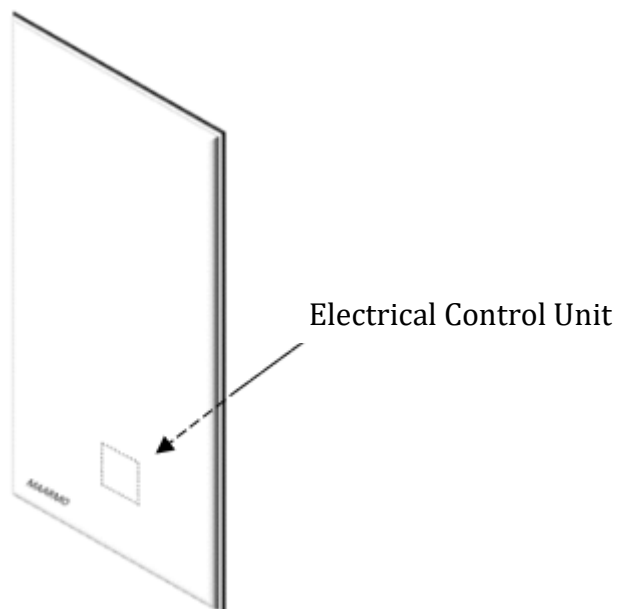

For proper installation of the MAARMO heater in a horizontal position, make sure that the MAARMO logo is located on the lower right side as shown and that the control unit (mounted on the back) is located on the right side of the heater.

FRONT VIEW IN  
ORIZONTAL POSITION

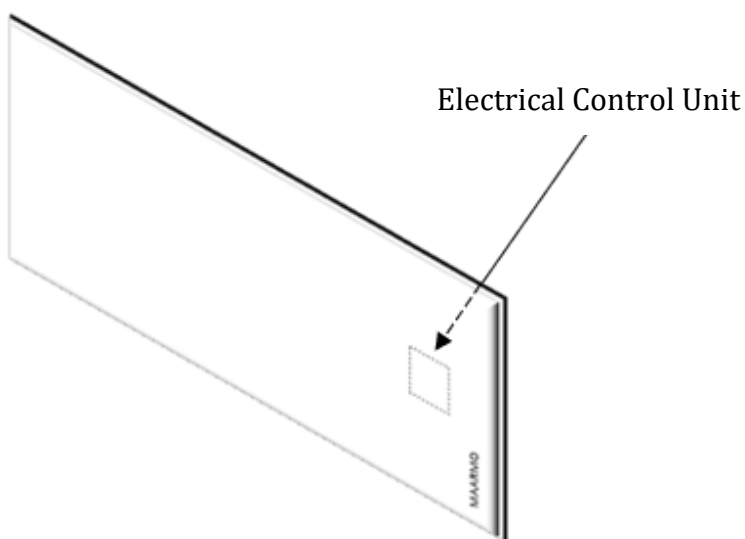

## Back view of the radiator

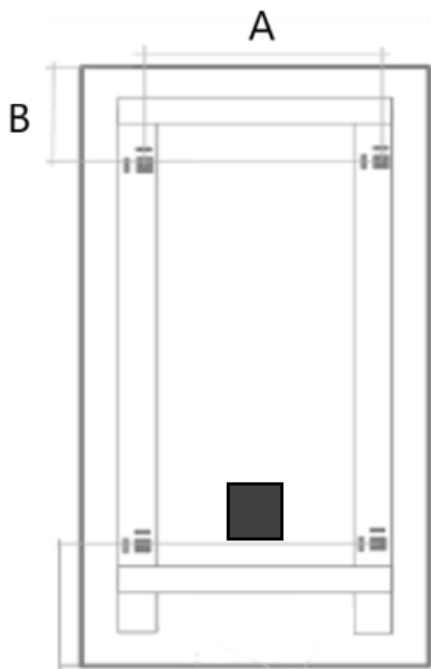

## Side view of the radiator

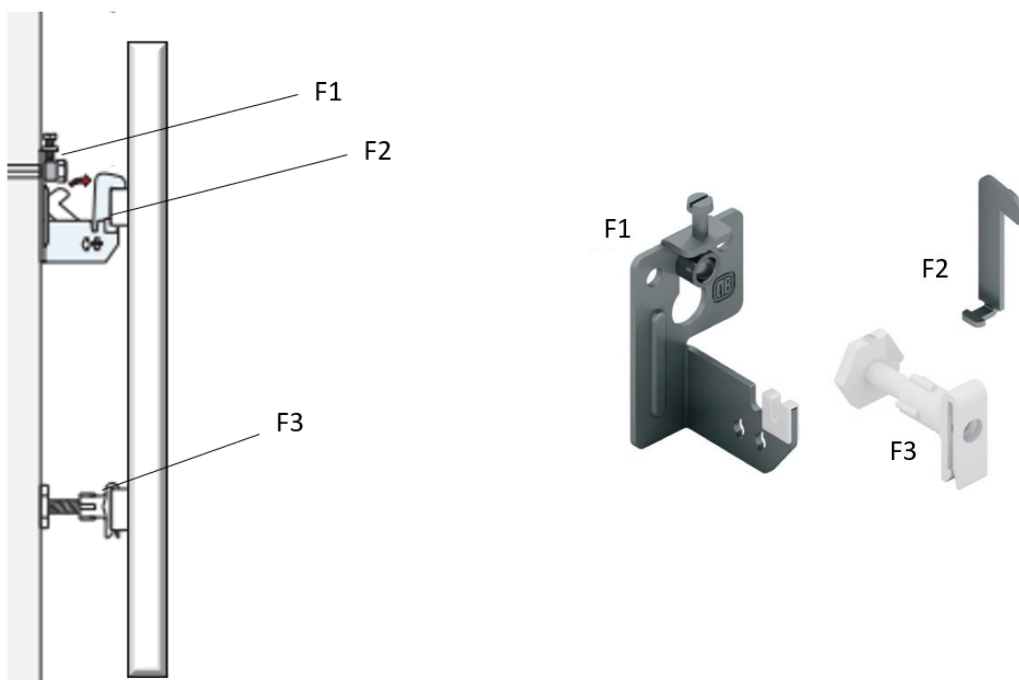

F1 = Hangers

F2= Anti-hook safety lock

F3= Spacer feets



As required by current regulations, the safety lock against hooking must be inserted after installation.

## 2.6 Electric connections



During installation, maintenance and cleaning, the heater must be switched off and not electronically powered.

The radiator must only be installed with a 230V 50Hz power supply. It is compulsory to install an omnipolar switch upstream of the radiator, with a minimum separation between contacts of 3mm.

This radiator is a class II device (meaning that it has double electrical insulation). Connection to earth is prohibited.

It is compulsory that the appliance's power supply circuit is protected by a highly sensitive differential protection device on the radiator's power supply line.

It is mandatory that the power supply cable be connected to the power supply via a junction box located 25 cm above the floor and without the use of an electrical plug.

If the power cable is damaged, it must only be replaced by a qualified electrician.

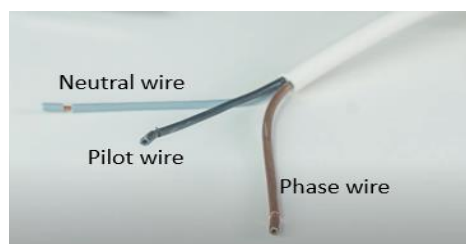

Brown wire		Phase/Live wire
Blue-grey wire		Neutral wire
Black wire		Pilot wire

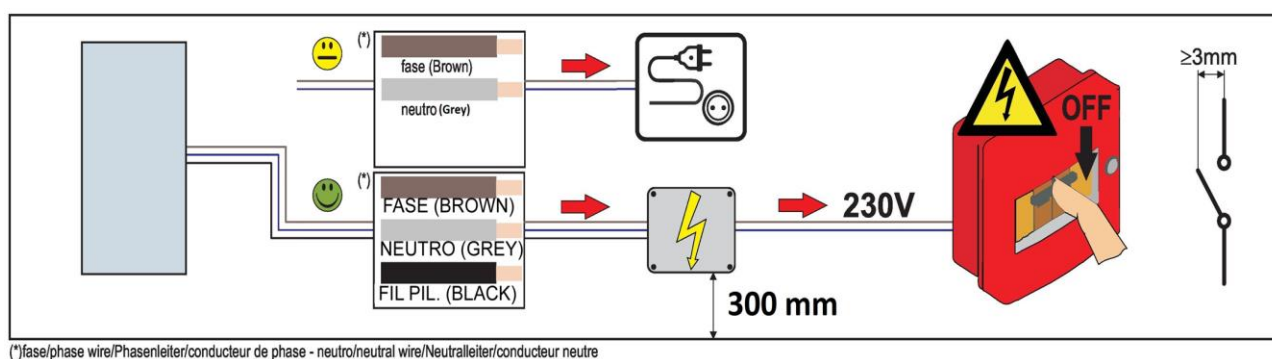

The FIL PILOT is a connection reserved for appliances connected to a chrono thermostat or an energy management unit. If these are not present, it is necessary, in accordance with safety standards, to isolate the FIL PILOT and not to connect it to the ground wire for any reason. The FIL PILOT must be used according to the protocol defined by GIFAM.



### 3. INSTALLATION STEPS

**3.1 STEP 1: Preparing the electrical plug** - For the connection to the domestic electricity network, rely on a qualified professional and on no account do it yourself.

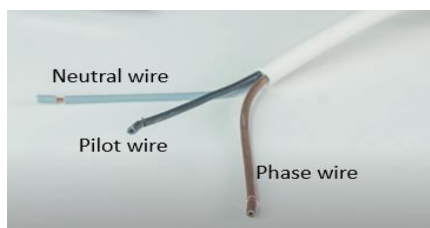

### 3.2 STEP 2: Installation

- Take measurements with a tape measure, respecting the safety distances between the radiator and the other elements of the wall ( picture 1 and 2)
- Using a drill (10 mm bit), drill a hole in the surface designated for the installation of the radiator (picture 3);
- Insert the dowel (F4) into the hole, place the hangers (F1) in the proximity of the holes and secure with a screw after inserting the spacer (F6) (picture 4 and 5).

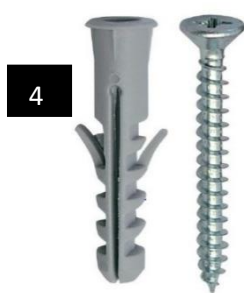

### 3.3 STEP 3: Installation on the wall

- place the anti-hooking safety lock (picture 1)
- hang the radiator on the wall bracket (picture 2/3/4)
- insert the anti-hooking safety lock tooth into the hole in the metal structure (picture 5)
- insert the retaining screw into the hole of the cover hanger (picture 6)
- Screw the retaining screw to the hanger and change the inclination by screwing/unscrewing the retaining screw (picture 7)
- Check that it is at the correct inclination using a spirit level (picture 8).
- Plug the spine into the electrical outlet (picture 9) and set the thermostat (picture 10).

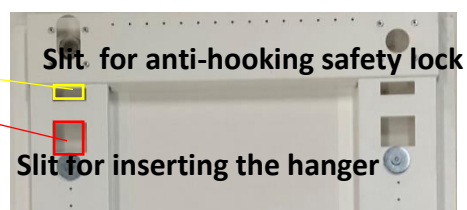

(horizontal mounting)

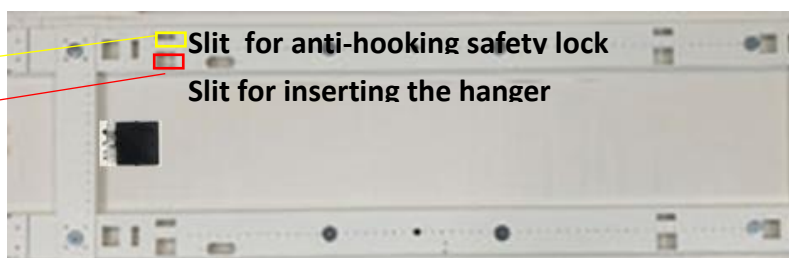

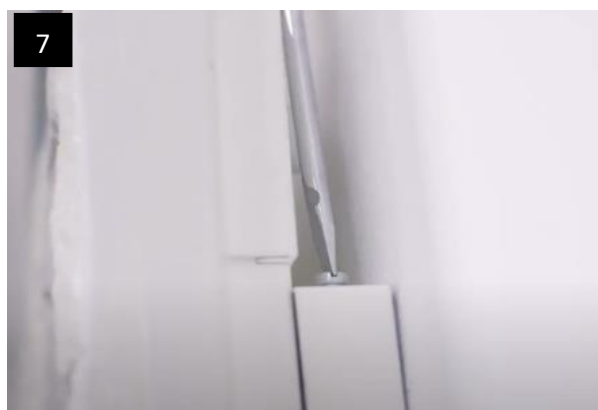
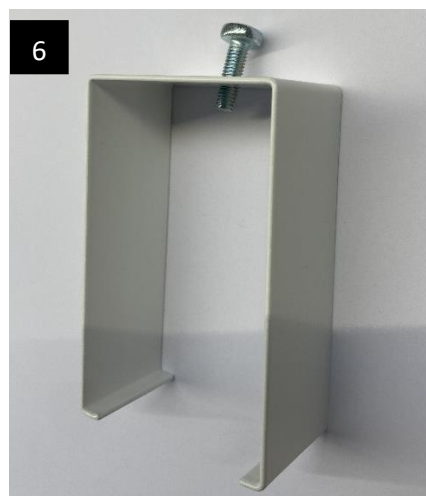
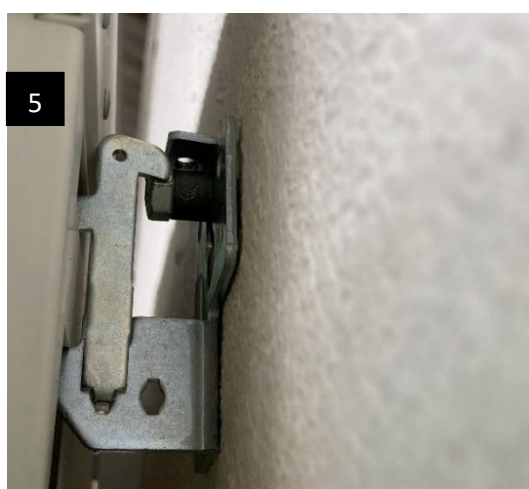
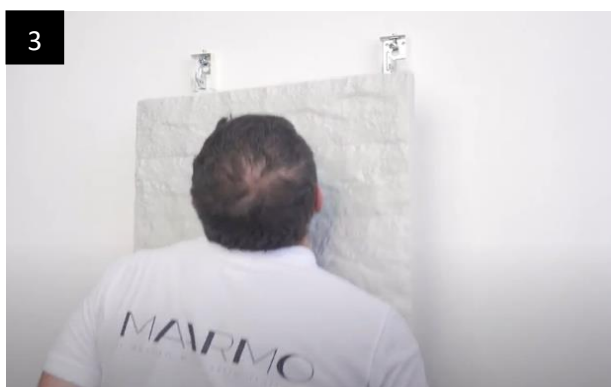

## 4. WARRANTY AND ASSISTANCE

The MAARMO decorative radiator warranty is valid if the product remains intact, without any modification or tampering.

Our warranty period is 24 months on the operation of the goods manufactured and/or supplied and a further 36 months on the heating body only (painting, integrity of the heating body, etc. excluding electrical parts and electronic control systems), starting from the date of shipment ex works (the date on the delivery note or accompanying invoice shall be taken as proof).

The warranty is strictly limited to the reimbursement or replacement, as we deem appropriate, of parts acknowledged to be defective after the products are returned in their original packaging to our factory at the purchaser's expense. Repair work on the products will be carried out exclusively at our factory.

The guarantee only covers non-wearing parts of our products. Wear parts (e.g. thermostat batteries) and their transport costs are not included.

No further compensation of any kind is due to the purchaser for direct / indirect damage suffered by the purchaser due to product defects.

The costs of disassembly and reassembly of the products, necessary to eliminate defects, are borne by the buyer if the products are out of warranty.

The guarantee is only valid if the products are used in a suitable environment and in an application that has been foreseen and included in the design of the products. Any improper use of the products is prohibited and will void the warranty.

Any variation of the above terms must be agreed in writing with MAARMO SRL.

The terms of the warranty are void if the product has been tampered with, damaged or is not in the state in which it was delivered.

We hereby declare under our sole responsibility that the products described in these instructions comply with all the essential requirements of the following directives and standards:

- LVD 2014/35/EU: EN60335-1 / EN60335-2-30 / EN62233;
- EMC 2014/30/EU: EN55014-1 / EN55014-2 / EN61000-3-2 / EN61000-3-3;
- ERP 2009/125/EC;
- Standard 2015/1188/EU;
- ROHS 2011/65/EU: EN50581.

UKCA MARKING

CE MARKING



For the guarantee to be valid, installation must be carried out in accordance with the laws and regulations in force in the country.

### 4.1 Technical assistance

For technical assistance, contact your installer or distributor.

## 5. DECLARATION OF CONFORMITY

MAARMO S.R.L. Via Cadore 4/B – 20, 33083 Villotta di Chions (PN), Italy declares under its own responsibility that the electric radiant heating panels model electric:

MAE0310, MAE0318, MAE0508, MAE0511, MAE0515, MAE0518, MAE0805, MAE1105, MAE1505 produced by MAARMO srl, are manufactured in compliance with European directives:

- DIRECTIVE 2006/95/EC of 12 December 2006 on the approximation of the laws of the Member States relating to electrical equipment intended for use within certain areas of application.

electrical equipment designed for use within certain voltage limits (low voltage)

- DIRECTIVE 2004/108/EC, for electromagnetic compatibility

- DIRECTIVE 2002/96/EC of 27 January 2003 on waste electrical and electronic equipment (WEEE).

And in accordance with harmonised standards:

- EN 60335-1 (2004-04): Safety of household and similar electrical appliances, General requirements.

- EN 60335-2-30 (2006-05): Safety of household and similar electrical appliances. Part 2-30: Particular requirements for room

Part 2: Particular requirements for room heaters.

- EN 60335-2-43: Safety of household and similar electrical appliances. Part 2-43: Particular requirements for clothes dryers

Part 2: Particular requirements for clothes dryers and towel dryers.

- EN 55014-1: 2000 + A1: 2001 + A2: 2002

- EN 61000-3-2: 2000

- EN 61000-3-3: 1995 +A1: 2001

- EN 55014-2: 1997 + A1: 2001

- EN 61000-4-2: 1995 +A1: 1999 +A2: 2001

- EN 61000-4-4: 1995 +A1: 2001 +A2: 2002

- EN 61000-4-5: 1995 +A1: 2001

- EN 61000-4-6: 1996 +A1: 2001

- EN 61000-4-11: 1994 +A1: 2001